

# Vortex™

**Instructions for installation and use - English**  
Electric cleaner  
Translation of the original instructions in french

**EN**

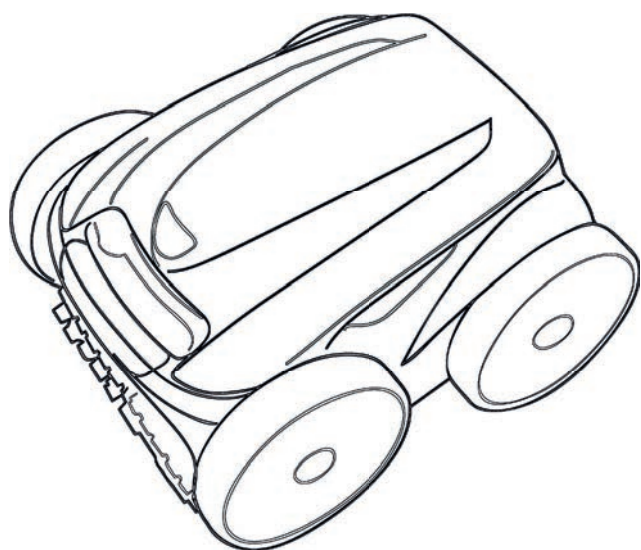

More documents on:  
[www.zodiac.com](http://www.zodiac.com)

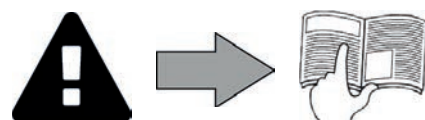

# WARNINGS

## GENERAL WARNINGS

- Failure to respect the warnings may cause serious damage to the pool equipment or cause serious injury, even death.
- Only a person qualified in the technical fields concerned (electricity, hydraulics or refrigeration) is authorised to perform this procedure. The qualified technician working on the appliance must use/wear personal protective equipment (such as safety goggles and protective gloves, etc.) in order to reduce the risk of injury occurring when working on the appliance.
- Before handling the appliance, ensure that it is switched off and isolated.
- The appliance is intended to be used only for swimming pools and spas; it must not be used for any purpose other than that for which it has been designed.
- It is important that the appliance is operated by people who are competent and qualified (both physically and mentally), after having read the instructions for use. All persons not meeting these criteria must not approach the appliance in order to avoid exposure to dangerous elements.
- Keep the appliance out of the reach of children.
- The appliance must be installed according to the manufacturer's instructions and in compliance with local standards. The installer is responsible for installing the appliance and for compliance with national installation regulations. Under no circumstances may the manufacturer be held liable in the event of failure to comply with applicable local installation standards.
- For any work other than the simple user maintenance described in this manual, the product should be referred to a qualified professional.
- Incorrect installation and/or use may cause serious damage to property or serious injuries (possibly causing death).
- All equipment, even postage and packing paid, travels at the risks and perils of the recipient. The latter shall issue reserves in writing on the carrier's delivery slip if damage is detected, caused during transport (confirmation to be sent to the carrier within 48 hours by registered letter). In the event that an appliance containing coolant has been turned on its side, mention your reservations in writing to the carrier.
- If the appliance suffers a malfunction, do not try to repair it yourself; instead contact a qualified technician.
- Refer to the warranty conditions for details of the permitted water balance values for operating the appliance.
- In addition to using spare parts manufactured by unauthorised third-party manufacturers, deactivating, eliminating or by-passing any of the safety mechanisms integral to the appliance, will automatically void the warranty.
- Do not spray insecticide or any other chemical (inflammable or non-inflammable) in the direction of the appliance, as this may damage the body and cause a fire.
- Zodiac® heat pump, filtration pump and filter appliances are compatible with the most commonly used types of pool water treatment systems.
- Do not touch the fan and/or any moving parts and do not insert anything, including your fingers in the vicinity of the moving parts while the appliance is in operation.

## WARNINGS ASSOCIATED WITH ELECTRICAL APPLIANCES

- The electrical supply to the appliance must be protected by a dedicated 30 mA differential residual current protection device (RCD), complying with the standards and regulations in force in the country where it is installed.
- Do not use an extension cord to plug in the appliance; plug it directly into a proper wall socket or outlet.
- Before carrying out any operations, check that:
  - The voltage indicated on the rating plate of the appliance corresponds to the mains voltage,
  - The power grid is adapted to the power requirements of the appliance, and is grounded.
  - The plug (where applicable) is suitable for the socket.
- In the event of abnormal function or signs of overheating such as a burning odour from the appliance, turn it off immediately, unplug / disconnect it from its power supply and contact a professional.
- Before accessing the enclosure for any reason, ensure that all power to the appliance and also power to any accessories or external devices which may be connected to the appliance, is disconnected from the mains power supply.
- Do not disconnect and reconnect the appliance to the power supply when in operation.
- Do not pull on the power cord to disconnect it from the power supply.
- If the supply cord is damaged, it must be replaced by the manufacturer, its service agent or similarly qualified persons in order to avoid a hazard.
- Do not attempt to carry out any servicing or maintenance operations with wet hands or while the appliance is wet.
- Ensure that all terminals for mains power are free in good condition and free of corrosion and/or dirt/debris.
- For any component or sub-assembly containing a battery: do not recharge or dismantle the battery, or throw it into a fire. Do not expose it to high temperatures or direct sunlight.
- In stormy weather, unplug the appliance to prevent it from suffering lightning damage.
- Do not immerse the appliance in water (with the exception of cleaners) or mud.

## SPECIFIC FEATURES APPLICABLE TO "Pool cleaners"

- The cleaner must operate in pool water with a temperature of between 15°C and 35°C.
- To avoid possible injury and damage to the cleaner, do not operate the cleaner out of the water.
- In order to prevent possible injury, bathing is prohibited when your cleaner is in the pool.
- Do not use the cleaner during shock chlorination.
- Do not leave the cleaner unattended for an extended period.

## WARNING ON THE USE OF A CLEANER IN A POOL WITH A VINYL SURFACE:

- Before installing your new cleaner, carefully inspect the lining of your pool. If the liner has eroded in some areas, or if you notice gravel, folds, roots or corrosion caused by metal on the inner surface of the liner, or if you notice that the support (bottom and walls) is damaged, do not install the cleaner before performing the necessary repairs or before replacing the liner using a qualified professional. The manufacturer cannot be held liable in any way for damage caused to the liner.
- The surface of certain vinyl patterned surfaces can wear rapidly and the patterns disappear on contact from objects such as cleaning brushes, toys, inflatable buoys, chlorine distributors and automatic pool cleaners. The decoration on some vinyl surfaces can be scratched or worn by basic friction such as through the use of a pool brush. The colours of certain patterns can also be erased during use or when in contact with objects in the pool. The erased patterns, wear or scratching of vinyl surfaces are not the liability of the manufacturer and are not covered by the limited warranty.

## Recycling



This symbol means that your appliance must not be thrown into a normal bin. It will be selectively collected for the purpose of reuse, recycling or transformation. If it contains any substances that may be harmful to the environment, these will be eliminated or neutralised.

Contact your retailer for recycling information.



- Before handling the appliance, it is vital that you read this installation and user manual, as well as the "warnings and warranty" booklet delivered with the appliance. Failure to do so may result in material damage or serious or fatal injury and will void the warranty.
- Keep and pass on these documents for later consultation during the appliance's service life.
- The distribution or modification of this document in any way is prohibited, without prior authorisation from Zodiac®.
- Zodiac® is constantly developing its products to improve their quality. The information contained herein may therefore be modified without notice.

## CONTENTS



### 1 Specifications 3

- 1.1 | Description 3
- 1.2 | Technical specifications and marking 5



### 2 Installation 6

- 2.1 | Set-up 6
- 2.2 | Attachment to the base or caddy assembly (depending on model) 6



### 3 Use 8

- 3.1 | Operating principle 8
- 3.2 | Pool preparation 8
- 3.3 | Immersing the cleaner 8
- 3.4 | Electricity supply connections 9
- 3.5 | Starting the cleaning cycle 10
- 3.6 | Ending the cleaning cycle 11
- 3.7 | Setting the time and programming the cleaning cycles (depending on the model) 12
- 3.8 | The remote control (depending on the model) 14



### 4 Maintenance 15

- 4.1 | Cleaning the filter 15
- 4.2 | Cleaning the propeller 16
- 4.3 | Replacing the brushes 17
- 4.4 | Changing the tyres 18



### 5 Troubleshooting 19

- 5.1 | Appliance behaviour 19
- 5.2 | User alerts 20
- 5.3 | Pre-diagnostic menu (depending on the model) 21



**Tip: to make it easier to contact your retailer**

Write down your retailer's contact details to help you find them more easily and fill in the "product" information on the back of the manual; your retailer will ask you for this information.







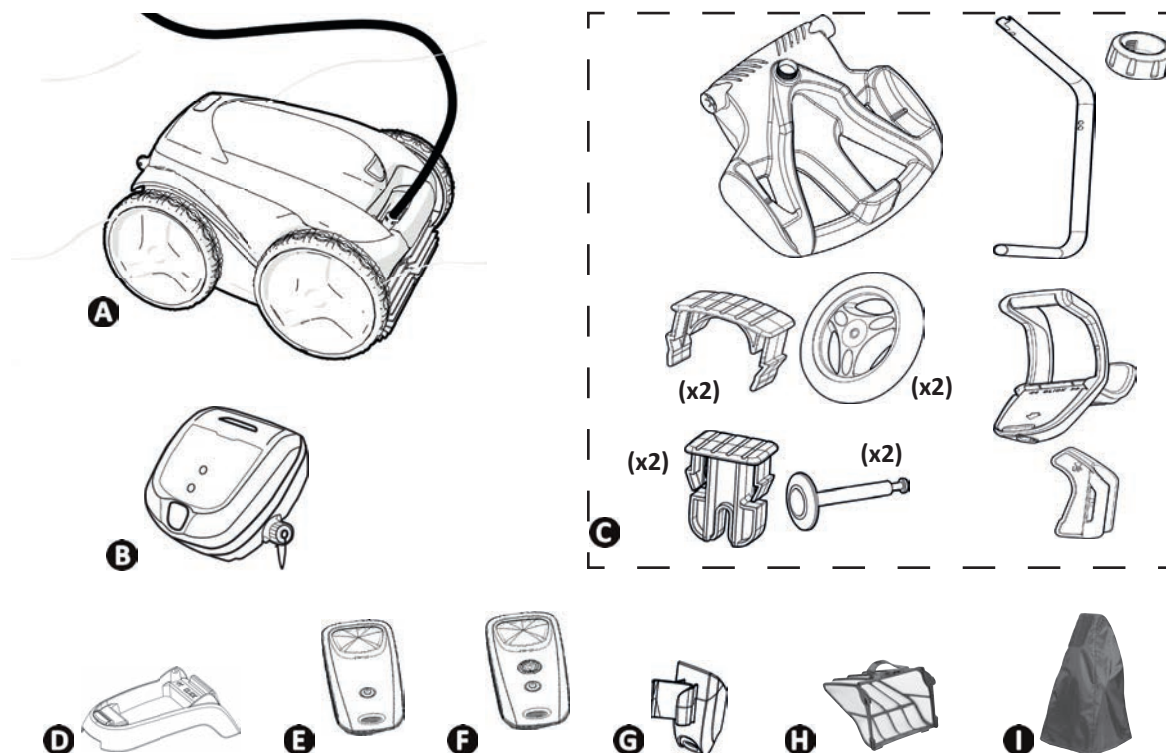









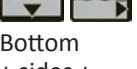

# 1 Specifications

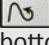
## 1.1 I Description

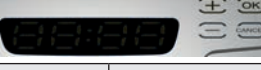

|   |  | OV 3300<br>RV 4200 | OV 3400 - OV 3410<br>- OV 3450 -<br>OV 3480 - RV 4310<br>- RV 4390 -<br>RV 4400 - RV 4430<br>Vortex™ 3 PLUS | RV 4460 | OV 3500 -<br>OV 3505 -<br>OV 3510<br>- Vortex™<br>4 PLUS | RV 4550<br>RV 4560 | OV 5300<br>OV 5330<br>RV 5300<br>RV 5400<br>RV 5470 | RV 5500<br>RV 5600 |
|---|--|--------------------|---|---------|--|--------------------|---|--------------------|
| A | Cleaner + floating cable                       | ✓                  | ✓   | ✓       | ✓  | ✓                  | ✓   | ✓                  |
|   | Front driving wheels (2WD)                     | ✓                  | ✓   | ✓       | ✓  | ✓                  |   |                    |
|   | Front/rear driving wheels (4WD)                |                    |   |         |  |                    | ✓   | ✓                  |
| B | Control box                                    | ✓                  | ✓   | ✓       | ✓  | ✓                  | ✓   | ✓                  |
| C | Caddy kit                                      | +                  | ✓   | ✓       | ✓  | ✓                  | ✓   | ✓                  |
| D | Base for control box                           | ✓                  |   |         |  |                    |   |                    |
| E | Kinetic remote control                         |                    |   |         | ✓  |                    |   |                    |
| F | Kinetic remote control "Remove from pool mode" |                    |   |         |  | ✓                  |   | ✓                  |
| G | Remote control support                         |                    |   |         | ✓  | ✓                  |   | ✓                  |
| H | 100µ fine debris filter                        | ✓                  | ✓   | ✓       | ✓  | ✓                  | ✓   | ✓                  |
|   | 200µ large debris filter                       | +                  | +   | +       | +  | +                  | +   | +                  |
|   | 60µ very fine debris filter                    |                    |   |         |  |                    |   |                    |
| I | Protective cover                               | +                  | +   | ✓       | +  | +                  | +   | +                  |

✓ : Supplied + : Available as an option

| Symbol  | Designation   | OV 3300<br>OV 3400<br>OV 3480<br>RV 4200<br>RV 4310 | OV 3410<br>OV 3450<br>RV 4390<br>Vortex™<br>3 PLUS | OV 3500<br>OV 3505<br>OV 3510<br>Vortex™<br>4 PLUS | RV 4400<br>RV 4430<br>RV 4460 | RV 4550 | RV 4560 | OV 5300<br>OV 5330<br>RV 5300 | RV 5400<br>RV 5470 | RV 5500<br>RV 5600 |
|---|---|---|--|--|-------------------------------|---------|---------|-------------------------------|--------------------|--------------------|
|    | Start/Stop the appliance  | ✓   | ✓  | ✓  | ✓                             | ✓       | ✓       | ✓                             | ✓                  | ✓                  |
|    | "Control" indicator   | ✓   | ✓  |  | ✓                             |         |         |                               |                    |                    |
|    | "Clean filter" indicator  |   |  |  | ✓                             | ✓       | ✓       | ✓                             | ✓                  | ✓                  |
|    | Remove from pool mode   |   |  |  | ✓                             | ✓       | ✓       |                               | ✓                  | ✓                  |
|    | <b>Surface to clean</b>   |   | ✓  | ✓  | ✓                             | ✓       | ✓       | ✓                             | ✓                  | ✓                  |
|   |  Bottom only                               |   | ✓  | ✓  | ✓                             | ✓       | ✓       | ✓                             | ✓                  | ✓                  |
|   |  Bottom + sides + water line               |   | ✓  | ✓  | ✓                             | ✓       | ✓       | ✓                             | ✓                  | ✓                  |
|   |  Waterline only                           |   |  |  |                               |         |         |                               |                    | ✓                  |
|  | <b>Pool shape</b>   |   |  |  |                               |         |         |                               |                    | ✓                  |
|   |  Flat bottomed rectangular               |   |  |  |                               |         |         |                               |                    | ✓                  |
|   |  Other shapes, other bottoms             |   |  |  |                               |         |         |                               |                    | ✓                  |
|  | <b>Cleaning intensity</b>   |   |  |  |                               |         |         |                               |                    | ✓                  |
|   |  Low intensity                           |   |  |  |                               |         |         |                               |                    | ✓                  |
|   |  Intensive                               |   |  |  |                               |         |         |                               |                    | ✓                  |
|   | Cleaning cycle programming<br>           |   |  |  |                               |         | ✓       |                               | ✓                  | ✓                  |
|   | Increase or reduce the cleaning time<br> |   |  | ✓  |                               | ✓       |         |                               |                    |                    |
|  | Switch on / off the remote control  |   |  | ✓  |                               | ✓       | ✓       |                               |                    | ✓                  |

✓ : Available

## ➤ 1.2 I Technical specifications and marking

### 1.2.1 Technical specifications

|                                  |                      |   |                               |            |
|----------------------------------|----------------------|---|-------------------------------|------------|
|                                  | OV 3300<br>RV 4200   | OV 3400 - OV 3410 - OV 3450 - OV 3480 -<br>OV 3500 - OV 3505 - OV 3510 - OV 5300 -<br>OV 5330 - RV 4310 - RV 4390 - RV 4400 - RV 4430<br>- RV 4460 - RV 5300 - RV 5400 - RV 5470<br>- Vortex™ 3 PLUS - Vortex™ 4 PLUS | RV 4550<br>RV 4560<br>RV 5500 | RV<br>5600 |
| Control box power supply voltage | 220-240 VAC, 50 Hz   |   |                               |            |
| Cleaner power supply voltage     | 30 VDC               |   |                               |            |
| Maximum power input              | 150 W                |   |                               |            |
| Cable length                     | 15 m                 | 18 m  | 21 m                          | 25 m       |
| Cleaner size (L x W x h)         | 43 x 48 x 27 cm      |   |                               |            |
| Package size (L x W x h)         | 69 x 43 x<br>46 cm   | 56 x 56 x 46 cm   |                               |            |
| Cleaner weight                   | 10.1 kg              |   |                               |            |
| Packaged weight                  | 14 kg                | 19 kg   |                               |            |
| Theoretical cleaning width       | 270 mm               |   |                               |            |
| Pump flow                        | 16 m <sup>3</sup> /h |   |                               |            |

### 1.2.2 Marking

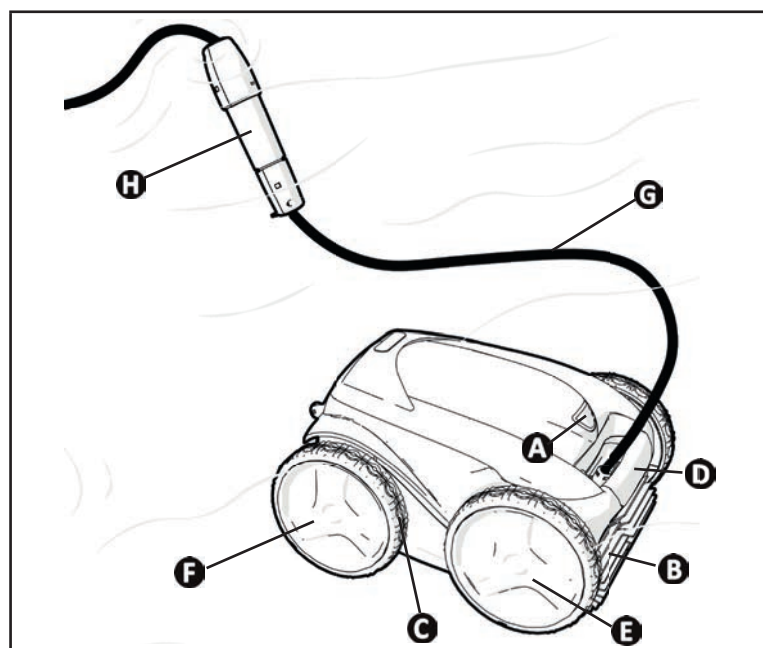

- A** : Filter access hatch lock
- B** : Brushes
- C** : Tyres
- D** : Transport and remove-from-pool handle
- E** : Front driving wheels
- F** : Rear driving wheels (depending on the model)
- G** : Floating cable
- H** : Swivel (depending on the model)

### 1.2.3 Product conformity

This appliance has been designed and built according to the following standards:

**Low voltage directive:** 2006/95/EC

**Electromagnetic compatibility directive:** 2004/108/EC

EN 55014-1: 2000 +A1:2001 +A2:2002; EN 55014-2: 1997 +A1:2002

EN 60335-1: 2002 + A1:2004 + A2:2006 +A11:2004 + A12:2006; EN 60335-2-41: 2003 + A1:2004

Relative to which it is compliant. The product has been tested under the normal conditions of use.

#### **SAFETY STANDARDS:**

The cleaners are classified by Intertek (ETL) as being compliant with the appropriate requirements of IEC 60335-2-41.





## 2 Installation

### 2.1 | Set-up

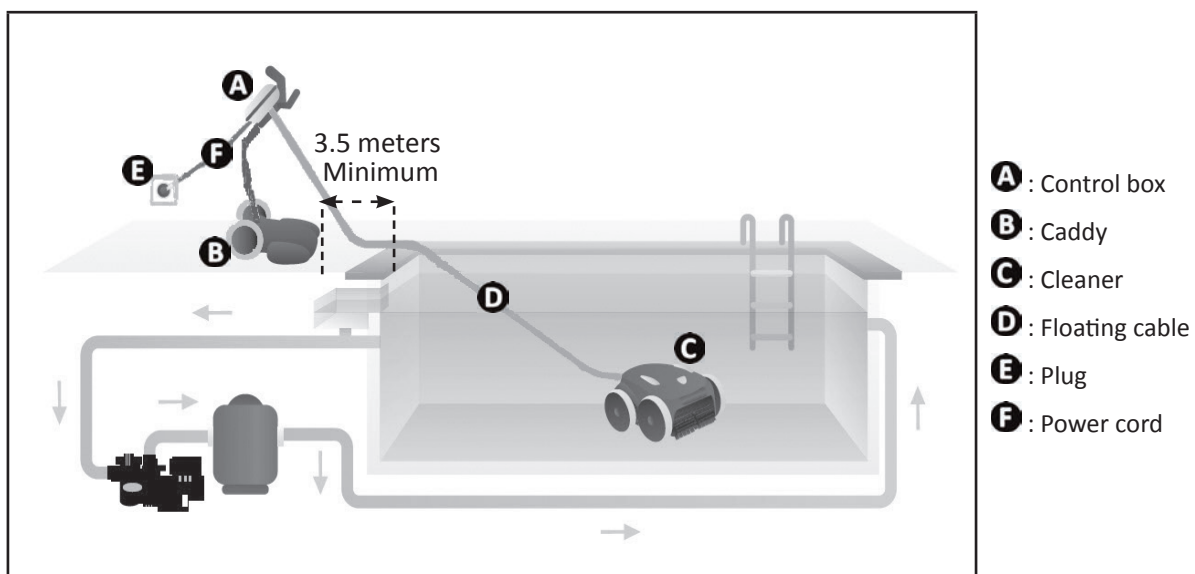

EN

### 2.2 | Attachment to the base or caddy assembly (depending on model)

#### 2.2.1 Attachment to the base

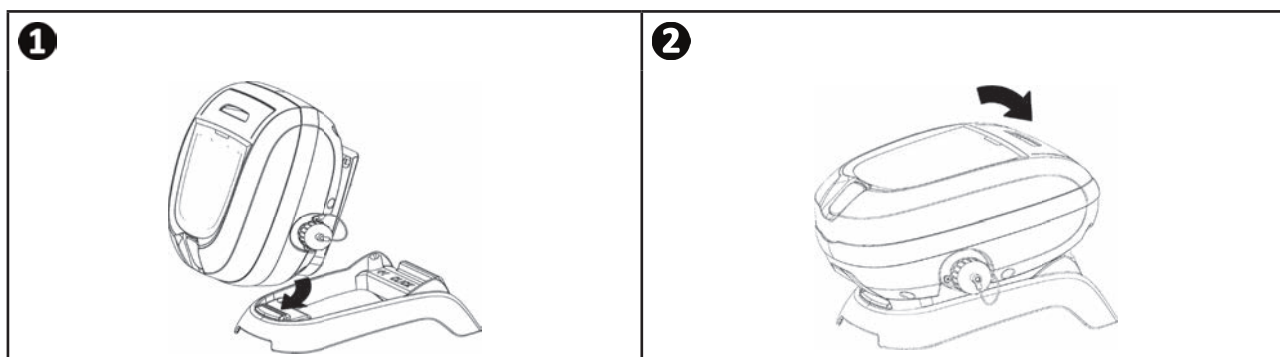

## 2.2.2 Caddy assembly



Tool-free assembly

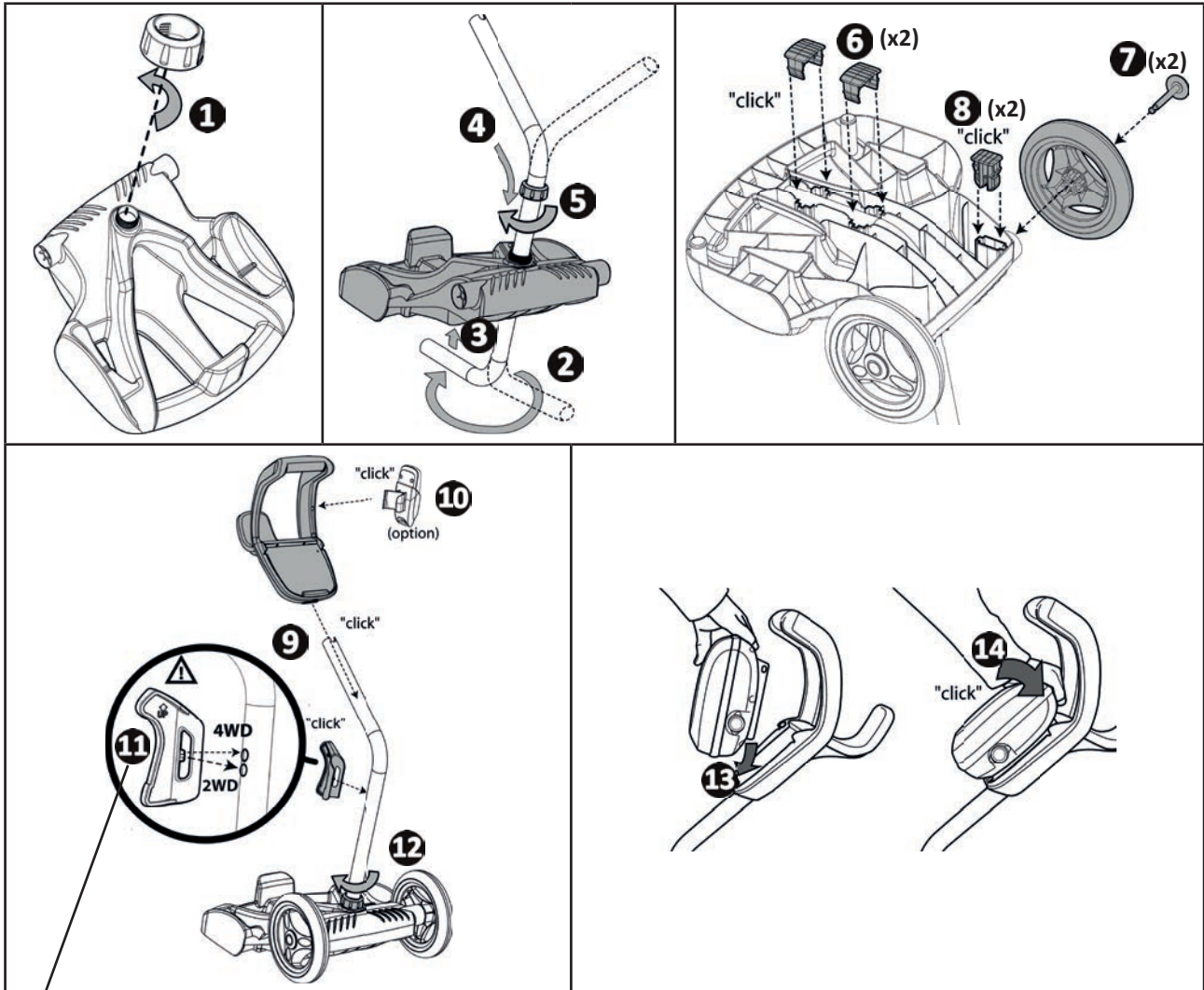

**11** For the number of driving wheels (2WD or 4WD), see: "1.1 I Description"





## 3 Use

### 3.1 | Operating principle

The cleaner is independent of the filtration system and can therefore operate autonomously. It just simply needs to be connected to the mains power supply.

It finds the best route to move around and clean the areas of the pool for which it has been designed (depending on the model: bottom, walls, water line). Debris is collected and stored in the cleaner's filter.

The control box enables the cleaning operations to be started, selected and programmed (depending on the model).

### 3.2 | Pool preparation



- This product is intended to be used in pools which are permanently installed. Do not use it in pools which may be dismantled. A permanent pool is built into the ground or on the ground and cannot be easily dismantled and stored.

EN

- The appliance must operate in pool water with the following properties:

|                   |                       |
|-------------------|-----------------------|
| Water temperature | Between 15°C and 35°C |
| pH                | Between 6.8 and 7.6   |
| Chlorine          | < 3 mg/l              |

- When the pool is dirty, especially when commissioning, remove the larger debris using a net in order to optimise the appliance's performance.
- Remove any thermometers, toys and other objects that might damage the appliance.

### 3.3 Immersing the cleaner

- Roll out the full length of the cable alongside the pool to avoid the cable becoming tangled during immersion (see image 1).
- Place the cleaner vertically into the water (see image 2).
- Move it slightly in all directions so that the air contained in the cleaner escapes (see image 3).
- It is essential that the appliance sinks on its own and settles on the pool bottom. While it is immersed, the cleaner draws the length of cable it needs into the pool (see image 4).

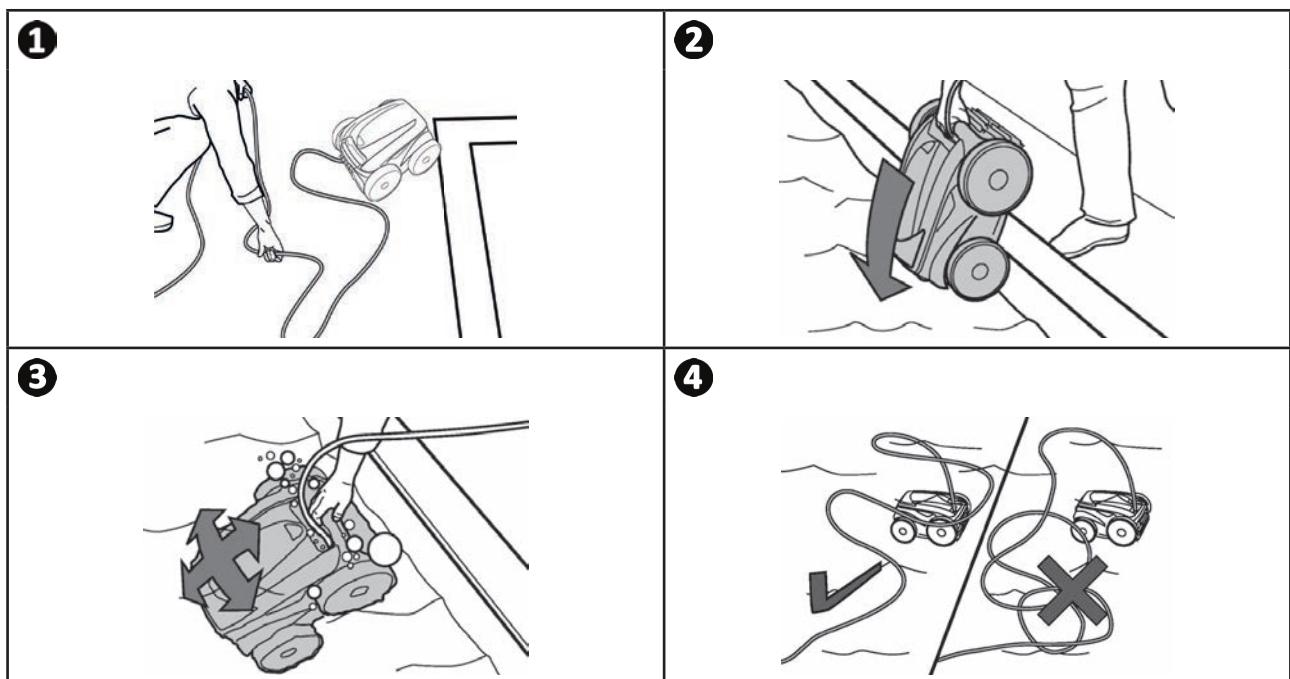

### 3.4 I Electricity supply connections

To prevent risk electrocution, fire, or serious injury, be sure to adhere to the following:



- Use of an electrical extension is prohibited when connecting the control box.
- Make sure that the socket can be easily accessed at all times and is protected from rain or splashes.
- The control box is splash-proof but must not be immersed. It must not be installed in a floodable area; keep it at least 3.5 metres away from the edge of the pool and avoid exposing it to direct sunlight.
- Place the control box near the socket.

- Unscrew the protective cap (see image 1).
- Connect the floating cable to the control box and lock it in place by turning the ring only in the clockwise direction (to prevent damage to the floating cable) (see image 2, 3).
- Make sure that the connector is fully pushed in so that no water can get in (see image 4).
- Connect the power cord (see image 5). Only connect the control box to a power outlet protected by a 30 mA maximum residual current device (if in doubt contact a qualified technician).

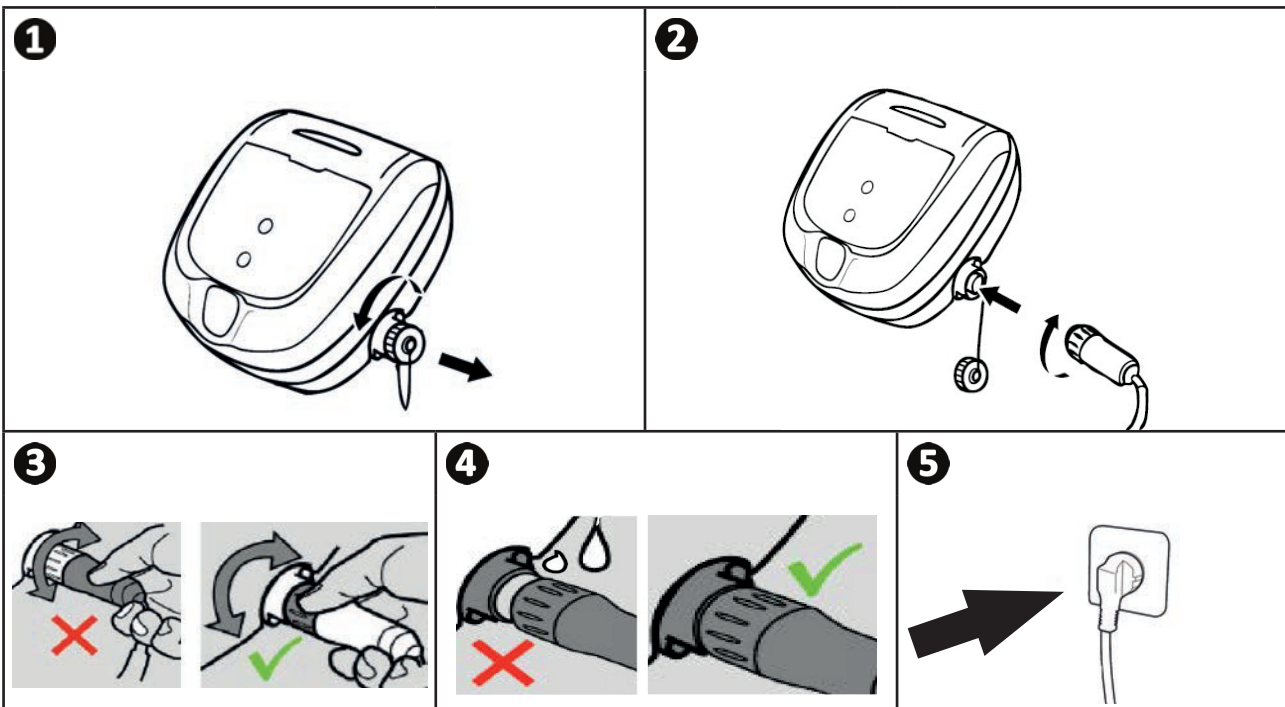

**Tip: choose the location of the control box carefully to prevent the cable from becoming tangled**

Place the control box in the centre of the pool's length, following the safety conditions relating to the electrical connection. This lets you limit the length of the floating cable to be put into the water to cover the pool, which simplifies set-up and storage operations.

### 3.5 I Starting the cleaning cycle



To prevent risk of injury or property damage, be sure to adhere to the following:

- Bathing is prohibited when the appliance is in the pool.
- Do not use the appliance during shock chlorination.
- Do not leave the appliance unattended for an extended period.
- Do not use the appliance if the roller shutter is closed.

- When the control box is powered up, the following symbols light up to indicate:
  - The action in progress
  - The cleaning mode selected
  - Maintenance required
- The control box switches to standby after 10 minutes and the screen is switched off. Press any key to exit standby mode. Standby mode does not stop the appliance if it is in a cleaning cycle.

EN

#### 3.5.1 Cleaning cycle selection (depending on model)

- A cleaning cycle is already configured by default: the symbols are on and the cleaning time appears on the screen, for example: **0:45** (depending on the model).
- The cleaning cycle can be selected at any time, before the appliance starts or while it is operating. The new cycle will be launched instantly and the remaining time countdown will be reinitialised.
- The cleaner adapts its movement strategy depending on the choice in order to optimise the coverage rate.

| Surface to clean            | Pool shape                  | Cleaning intensity |
|-----------------------------|-----------------------------|--------------------|
| Bottom only                 | Other shapes, other bottoms | Low intensity      |
| Bottom + sides + water line | Flat bottomed rectangular   | Intensive          |
| Waterline only              |                             |                    |

#### 3.5.2 Launching the cleaning cycle

- Press



##### Tip to improve cleaning performance

At the start of the bathing season, launch several cleaning cycles in bottom-only mode (after removing large debris with a net). Regular use of the cleaner (without exceeding 3 cycles per week) means that your pool will always be clean and the filter less clogged.

#### 3.5.3 Adjusting the cleaning time (depending on model)

- You may reduce or increase the time for the cleaning cycle selected or in progress:
  - : Reduce by 30 minutes.
  - : Increase by 30 minutes.
- Press to confirm.

## ➤ 3.6 I Ending the cleaning cycle



- To prevent damaging the equipment :

- Do not pull on the cable to remove the appliance from the pool. Use the handle.
- Do not leave the appliance to dry out in sunlight after use.
- Store all the elements away from sunlight, humidity and bad weather.
- Screw the protective cap back on if you unplug the control box power cord.

- Switch off the appliance by pressing .
- When the cleaner is within arm's reach, pick it up by the handle and lift it gently out of the pool so that the water it contains drains into the pool (see image **1**).
- Place the cleaner vertically in the location provided on the caddy (depending on the model) for it to dry out quickly (see image **2**).
- Then store it with the control box away from sunlight and any splashes. A protective cover is available as an option (see image **3**).

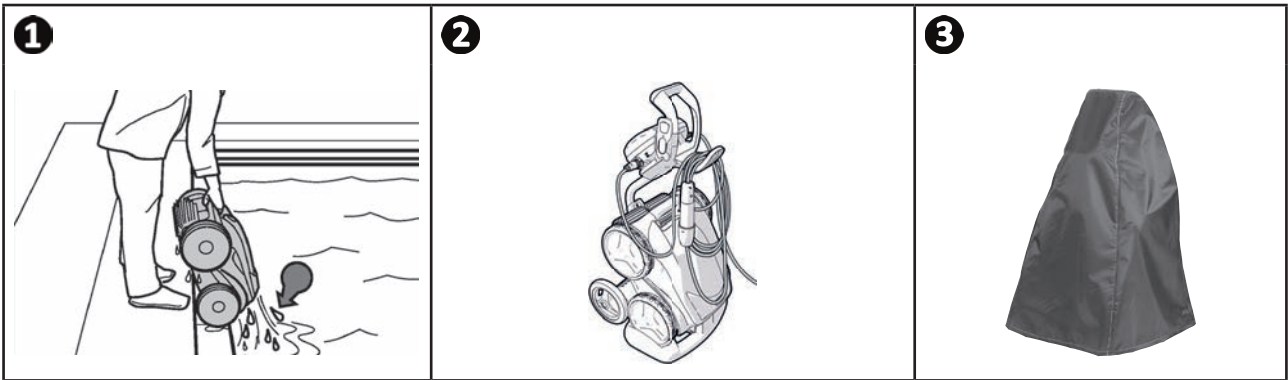

### 3.6.1 "Remove from pool" mode (depending on the model)

This function enables the cleaner to return to an exact point at the edge of the pool. When it climbs the wall, the cleaner sprays a jet of water behind it to make it lighter as it exits the pool.

- Direct the cleaner towards the required pool wall, then make it climb to the water line: hold  down to rotate it. The cleaner moves towards the wall when you release the button.



#### **Tip to prevent the floating cable from becoming tangled**

The cleaner's behaviour is strongly impacted by the tangling of the cable. A cable that is correctly untangled will guarantee better coverage of the pool.

- Untangle the cable and lay it out in the sun so that it returns to its original shape.
- Then wind it up carefully and place it on the caddy handle (depending on the model) or on a fixed support.

### 3.7.1 Setting the time and programming the cleaning cycles (depending on the model)



- Do not disconnect the power cable once the time has been programmed or you will lose it. The time setting will be saved for approximately 2 minutes if the power supply is disconnected.

#### 3.7.1 Setting the time

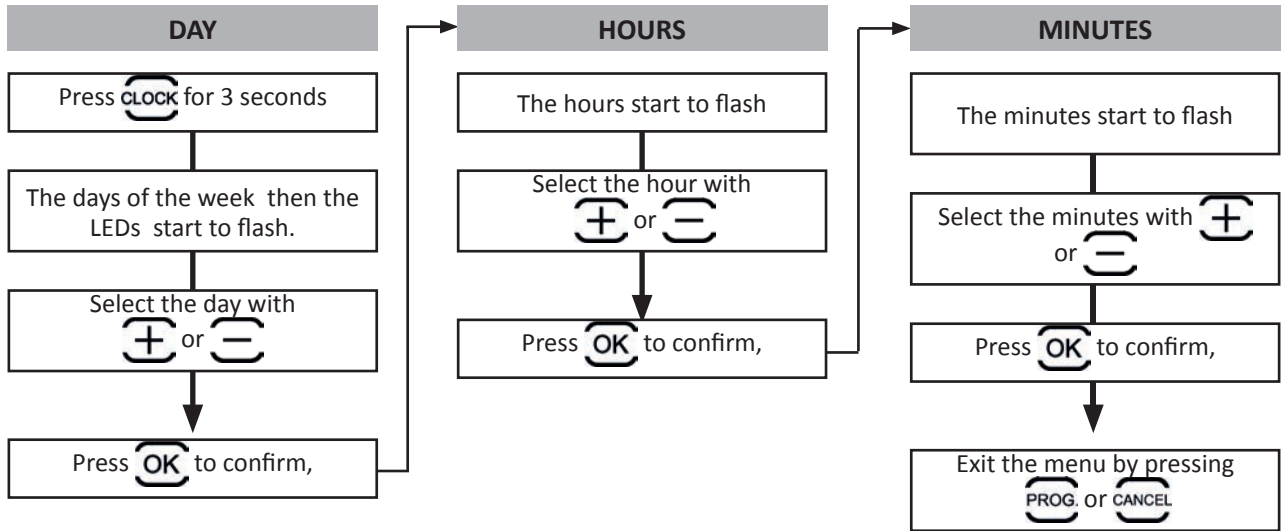

**Tip: check the time setting**

Stopping the appliance if a cleaning cycle is in progress. Press . The time is displayed for 5 seconds.

### 3.7.2 Programming cleaning cycles

Program **up to 7 cleaning cycles** (for example, 2 days per week: Wednesdays and Saturdays over 4 weeks).

- You must set the time before you program the cleaning cycles, see § “3.7.1 Setting the time”.
- Start by selecting the cleaning cycle on the control box, see § “3.5.1 Cleaning cycle selection (depending on model)”.
- Then program the days, hours and minutes.

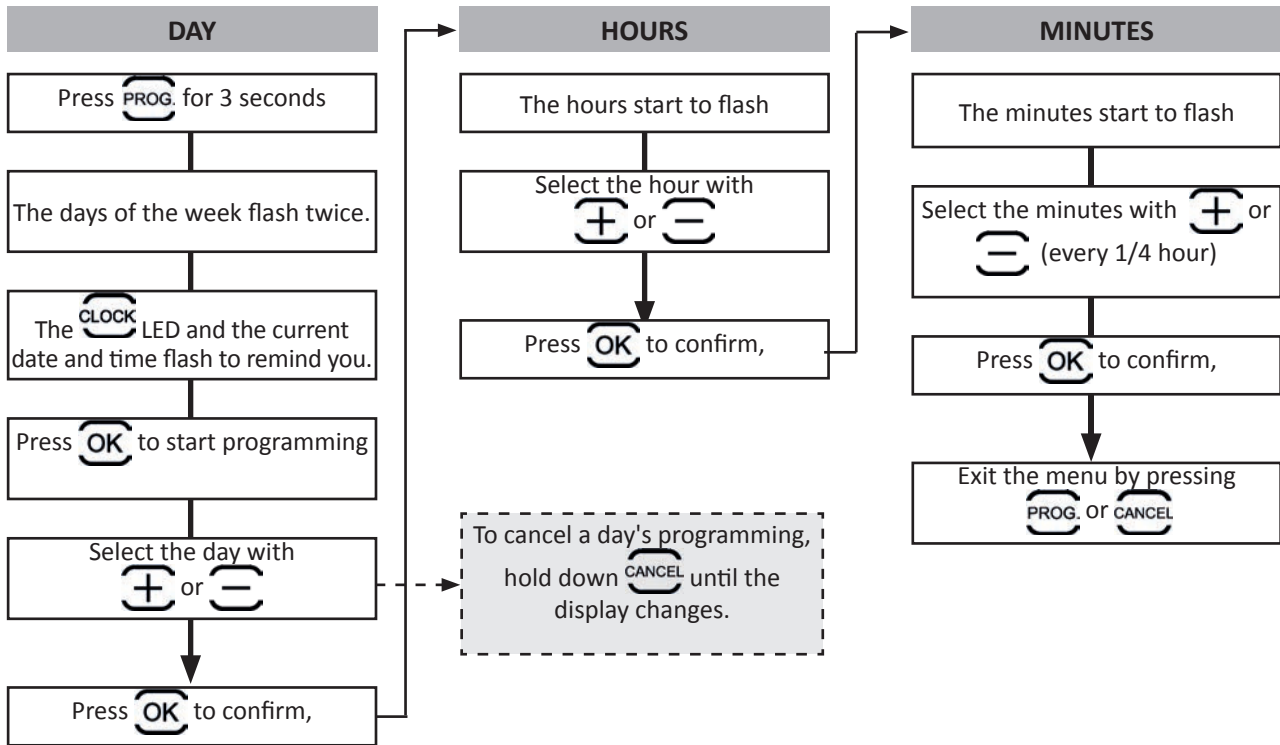

- The programming stops automatically at the end of the 7th cleaning cycle and the LED **PROG.** switches off.
- To cancel ALL the programming, exit the menu **PROG.** and hold down **CANCEL** until the display changes.



**Tip: check the programming**



Press **PROG.** Each programming is displayed for 3 seconds.

### 3.8 I The remote control (depending on the model)



- Respect the battery polarity.
- Do not recharge the battery, dismantle it or throw it onto a fire.
- Do not expose it to high temperatures or direct sunlight.

#### 3.8.1 Switching the remote control on and off

- To switch on: press .
- To switch off: press and hold .



**Tip: improve the remote control reception.**

The frequency of the flashing of the led located on the remote control indicates the reception quality. If the LED flashes quickly, reception quality is OK.

For the best communication between the control box and the remote control:

- Position the control box on the caddy.
- Turn the control box towards the pool
- Removal all large obstacles between the control box and the pool.

EN

#### 3.8.2 Directing the cleaner

- The remote control is equipped with movement sensors to direct the cleaner:

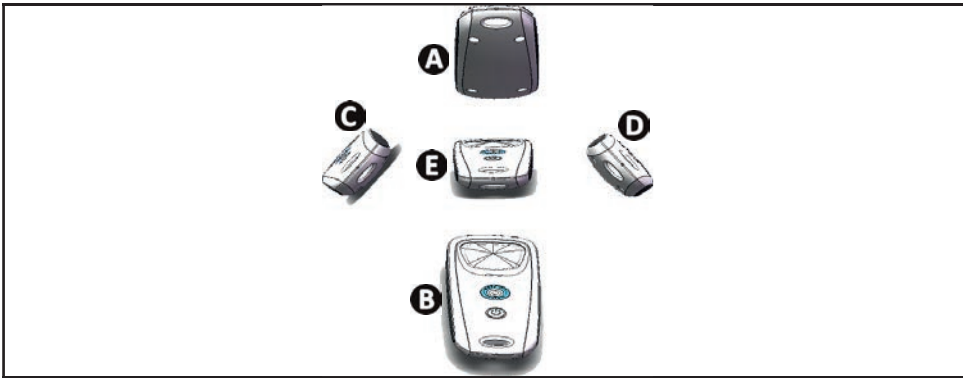



- A** : Forward
- B** : Backwards
- C** : Left turn
- D** : Right turn
- E** : Stop

#### 3.8 Taking the cleaner out of the water (depending on the model)

- Press . The cleaner moves toward the wall and climbs up to the waterline.

#### 3.8.4 Synchronising the remote control with the control box

By default, the remote control is already synchronised with the control box. If replacing the remote control/control box or if a synchronisation problem occurs, follow the steps below:

- Place the remote control a **maximum of 50 cm** away from the control box.
- Connect the control box, check that the display shows the operating time, and that no cleaning cycle is running.
- Switch on the remote control by pressing .
- Before the remote control switches to standby (around 45 seconds) press the  and  buttons simultaneously for 6 seconds.
- Check that synchronisation was successful by observing the display and the remote LED:

| Display on the control box             | Remote LED | Result  |
|--|------------|---|
| <b>Good</b> → <b>0:45</b><br>2 seconds | Flashing   | <ul style="list-style-type: none"> <li>• Synchronisation successful.</li> </ul>   |
| <b>FAIL</b>                            | On steady  | <ul style="list-style-type: none"> <li>• Check the distance between the control box and the remote control is 50 cm maximum.</li> <li>• Check the remote control batteries. Replace them if necessary. If the problem continues contact your retailer.</li> </ul> |



## 4 Maintenance

- The appliance must be cleaned regularly using clean or slightly soapy water. Do not use solvents.
- Rinse the appliance thoroughly with clean water.
- Do not let your appliance dry in the sun by the pool.



**Tip: replace the filter and brushes every 2 years**

You are encouraged to change the filter and the brushes every 2 years to preserve the integrity of the appliance and guarantee optimum performance.

### 4.1 | Cleaning the filter



- The cleaner's performance may be reduced if the filter is full or dirty.
- Clean the filter regularly with clean water for efficient pool cleaning.
- If the filter is clogged, clean it with an acidic solution (spirit vinegar, for example). It is recommended that you do this at least once a year, since the filter will clog if not used for several months (winterising period).

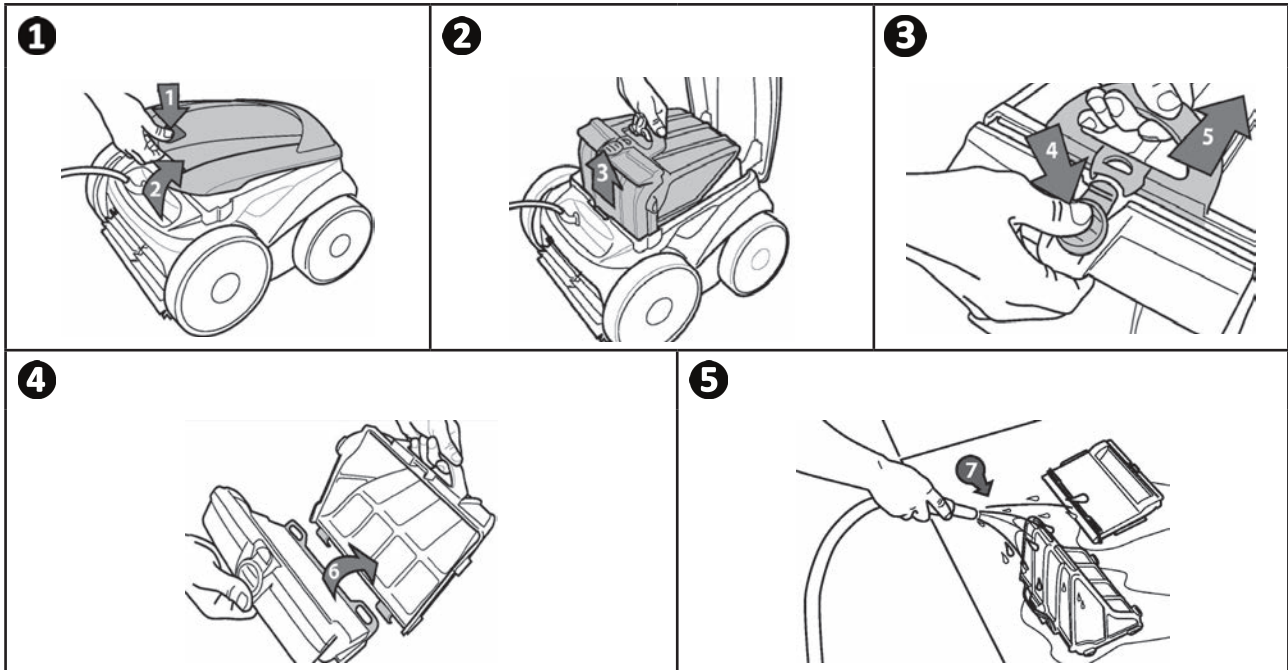

**Tip: Check the status of the "filter cleaning" indicator  (depending on the model)**

We recommend that you clean the filter as soon as the LEDs light up.



## 4.2 I Cleaning the propeller

To avoid serious injury:



- Disconnect the cleaner from the power supply.

- Wear gloves when maintaining the propeller



- Loosen the screw on the grid (see image 1).
- Remove the grid (see image 2).
- Remove the flow guide carefully (see image 3).
- To remove the propeller, wear gloves and hold the end of the propeller carefully when pushing it (see image 4).
- Remove all debris (hair, leaves, stones, etc.) which may be blocking the propeller.

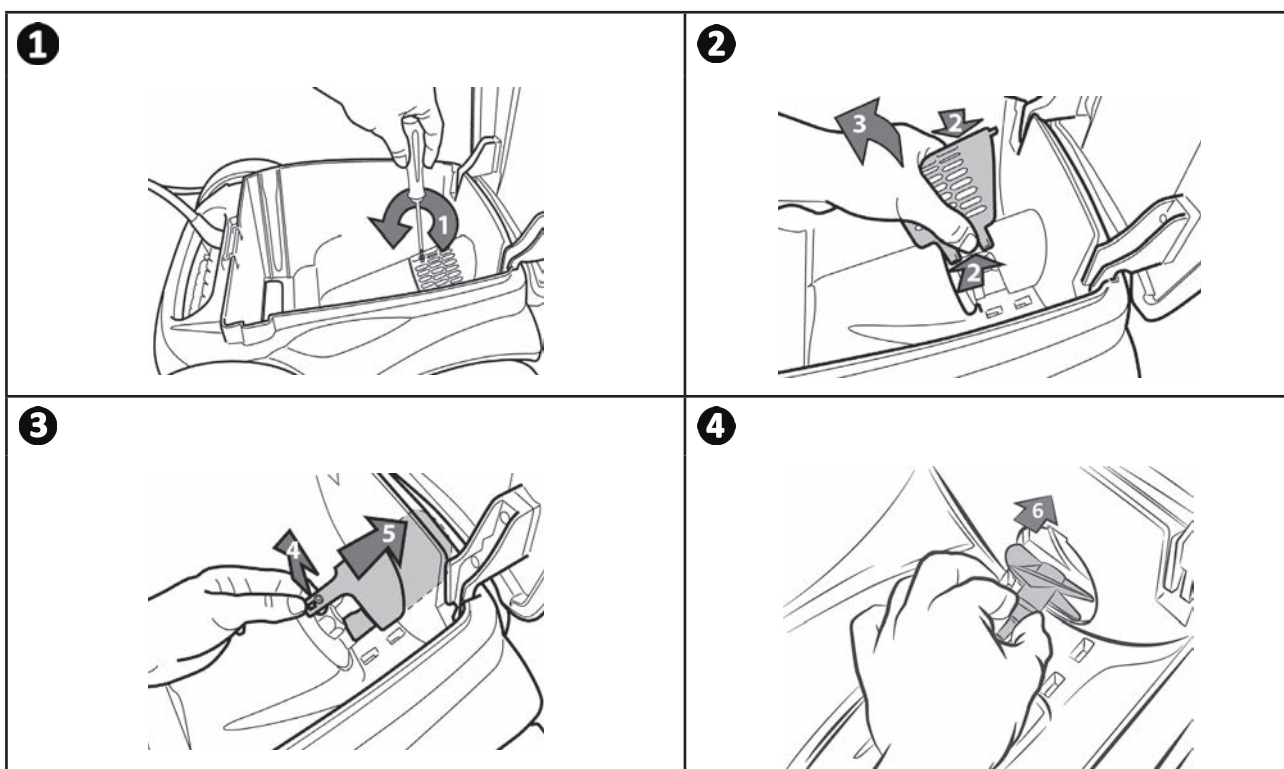

EN

### ➤ 4.3 I Replacing the brushes

- Each brush is equipped with wear indicators; the distance between the indicators and the end of the brush indicates whether the brush is in good condition (see image **1**).
- The brushes are worn and should be replaced when the wear indicators appear as shown in image **2**.
- To remove worn brushes, remove the tabs from the holes in which they are fixed (see image **3**).
- To fit new brushes, start by fitting the side without tabs under the brush holder (see image **4**).
- Roll the brush around its support, slide the tabs into the attachment holes and pull on the end of each tab until its edge passes through the slit (see image **5**).
- Cut the tabs using a pair of scissors for them to be level with the other blades (see image **6**).

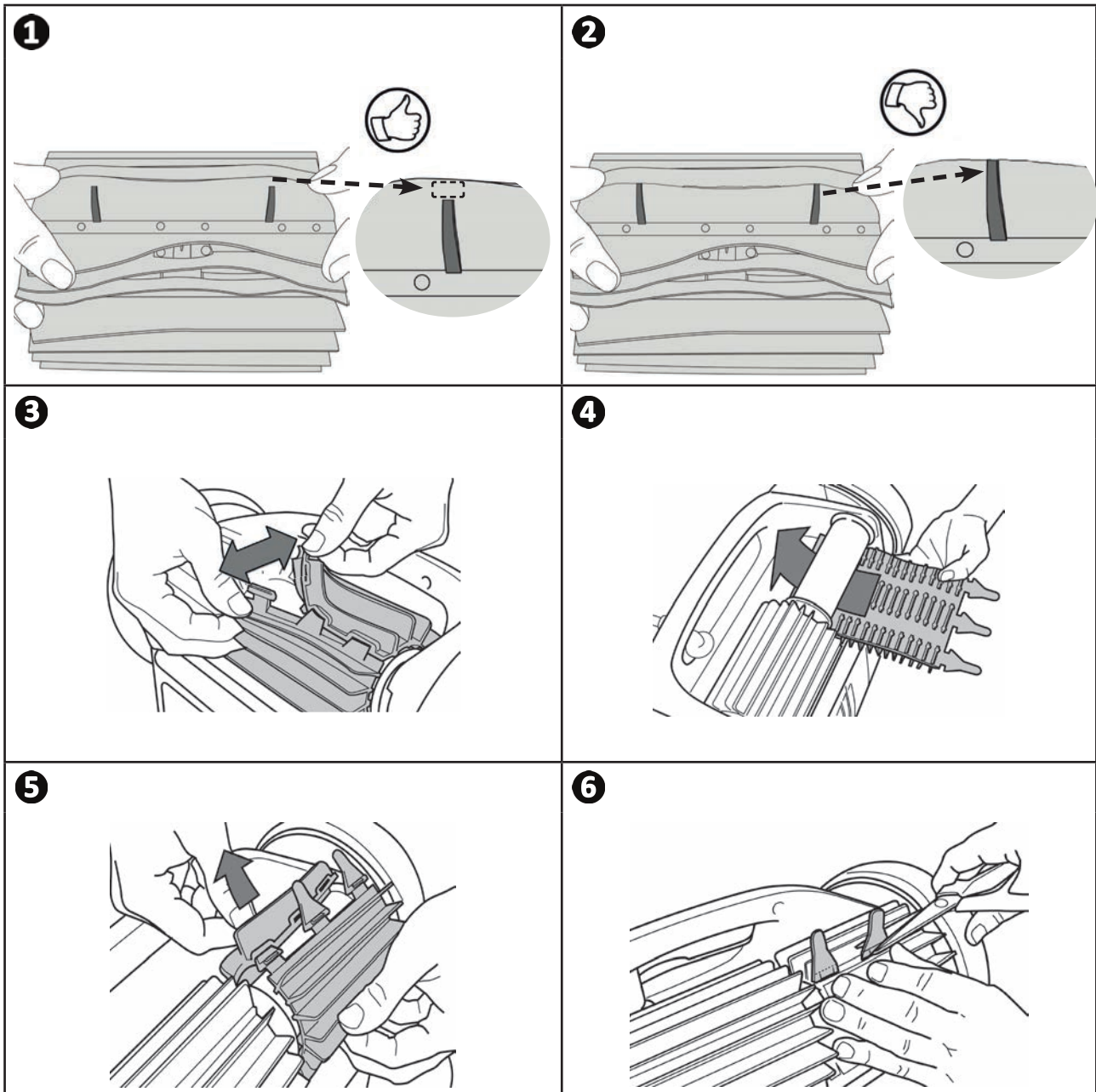

▶ 4.4 | Changing the tyres

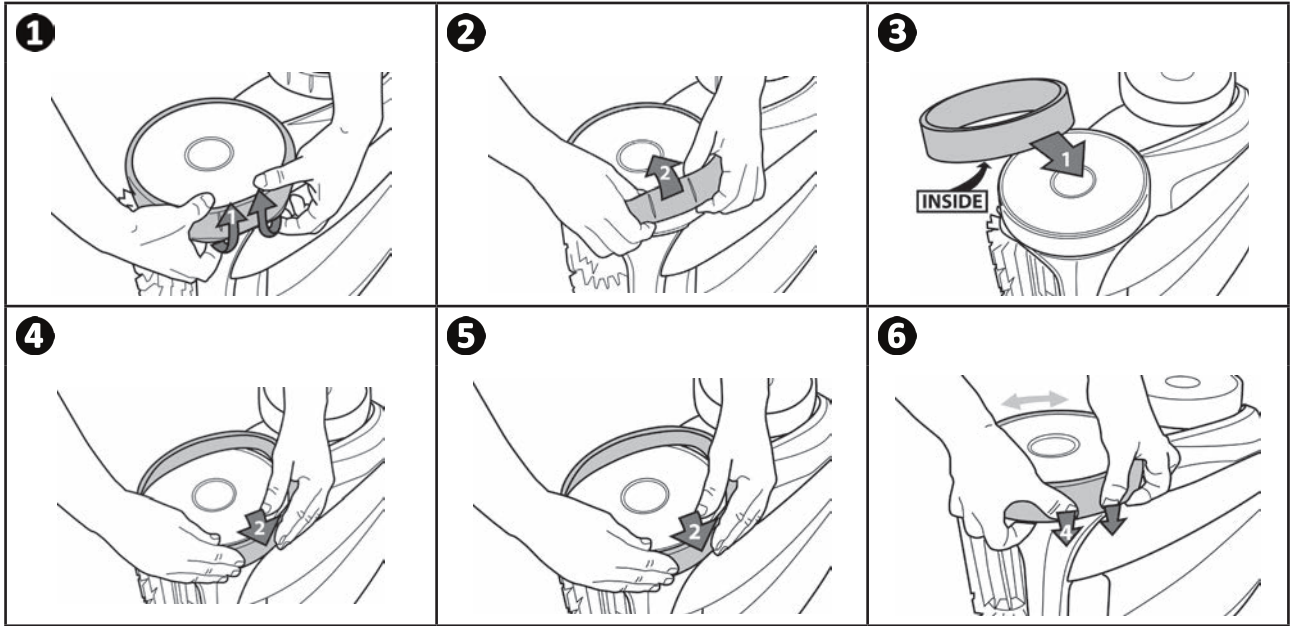

EN







## 5 Troubleshooting







- If a problem occurs, before you contact your retailer, please carry out these few simple checks using the following tables.
- If the problem continues, contact your retailer.
-  : Actions to be performed by a qualified technician only.

### 5.1 I Appliance behaviour

|   |  |
|---|--|
| Part of the pool is not correctly cleaned   | <ul style="list-style-type: none"> <li>• Repeat the immersion steps (see § “3.3 Immersing the cleaner”), varying the immersion location until you find the right place in the pool.</li> </ul>   |
| The appliance does not stay firmly on the pool bottom   | <ul style="list-style-type: none"> <li>• There is still air in the appliance's casing. Repeat the immersion operations (see § “3.3 Immersing the cleaner”).</li> <li>• The filter is full or dirty: clean it.</li> <li>• The filter is clogged: change it.</li> <li>• The propeller is damaged, <b>contact your retailer</b> </li> </ul>  |
| The appliance does not or no longer climbs the pool sides as it originally did.<br>(Its electronic programme means that the appliance does not systematically climb the walls). | <ul style="list-style-type: none"> <li>• The filter is full or dirty: clean it.</li> <li>• The filter is clogged: change it.</li> <li>• Even though the water seems clear, microscopic algae are present in your pool. They are not visible to the naked eye, and they make the sides slippery and prevent the appliance from climbing. Carry out shock chlorination and slightly reduce the pH. <b>Do not leave the appliance in the water during shock treatment.</b></li> <li>• The brushes are worn: check the wear indicators “4.3 I Replacing the brushes”, then turn the brushes to check the rotations. Replace the brushes where necessary.</li> <li>• <b>If the problem continues, contact your retailer.</b> </li> </ul> |
| The appliance does not move on start-up.  | <ul style="list-style-type: none"> <li>• Check that the control box's power socket is receiving a power supply.</li> <li>• Check that a cleaning cycle has been launched and that the lights are on.</li> <li>• <b>If the problem continues, contact your retailer.</b> </li> </ul>   |
| The cable gets tangled  | <ul style="list-style-type: none"> <li>• Do not unroll the entire length of the cable into the pool.</li> <li>• Place the required length of cable in the pool and spread the rest along the side of the pool.</li> </ul>  |
| The cleaner's discharge nozzles or bottom plug holes become blocked   | <ul style="list-style-type: none"> <li>• Stop the filtration pump and begin a new cleaning cycle.</li> <li>• Place the control box in the centre of the pool's length, following the safety conditions, see “3.4 I Electricity supply connections”. If cleaning is not optimal, vary the location of the control box and the place at which the cleaner enters the pool.</li> </ul>  |
| The cleaner climbs the walls slowly and stops under the water line  | <ul style="list-style-type: none"> <li>• The cleaner may behave differently depending on the lining of the pool.</li> </ul> <p>A parameter may require changing. To do this, <b>contact your retailer.</b> </p>   |
| The cleaner climbs the walls quickly and goes past the water line, aspirating air   |  |
| The control box does not respond to any button presses  | <ul style="list-style-type: none"> <li>• Unplug the power cord from the mains socket, wait 10 seconds and plug it back in again.</li> </ul>  |
| The screen displays the message  when the remote control mode is active                      | <ul style="list-style-type: none"> <li>• This means that the remote control batteries are too low: change them.</li> </ul>   |

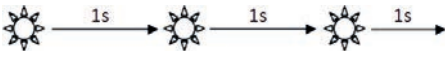

|   |   |
|---|---|
| The remote control LED is flashing slowly or the LED is steadily lit. | <b>Remote control range problem:</b> <ul style="list-style-type: none"> <li>Position the control box on the caddy at least 3.5 metres from the pool.</li> <li>Orient the control box towards the pool in order to improve the range of the remote control. Ensure there are no large obstacles between the control box and the pool.</li> </ul> |
| The remote control LED is steadily lit.                               | <ul style="list-style-type: none"> <li>Synchronisation problem: repeat the synchronisation steps (see §"3.8.4 Synchronising the remote control with the control box").</li> </ul>   |

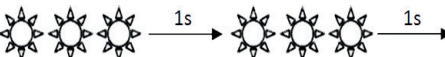
## ➤ 5.2 I User alerts

| User alerts (depending on the model)   |  | Solutions  |
|--|--|--|
| Flashing LED:<br> | Error code:<br> |  |
|                   | Er: 10   | <ul style="list-style-type: none"> <li>Check that the cleaner is correctly connected to the control box. If necessary, unplug it and reconnect it following the appropriate procedure.</li> </ul>            |
|                   | Er: 02<br>Er: 03<br>Er: 05<br>Er: 06   | <ul style="list-style-type: none"> <li>Check that there is nothing preventing the brushes and wheels from turning. To do so, turn the wheels (1/4 turn) to release any debris that may be jammed.</li> </ul> |
|                 | Er: 07<br>Er: 08   | <ul style="list-style-type: none"> <li>Cleaner operating outside the pool. Make sure you start the cleaner when it is in the water (see § "3.3 Immersing the cleaner").</li> </ul>                           |
|  | Er: 01<br>Er: 04   | <ul style="list-style-type: none"> <li>Check that there are no stones or hair in the propeller.</li> <li>Clean or change the filter if necessary.</li> </ul>   |

EN

### 5.2.1 Error codes

- Pressing a key deletes the error code and turns off the control box.
- The screen switches to standby after 10 minutes. To turn the screen back on, press any key.
- When an error is detected, the control box temporarily suspends the programme (the  LED is turned off).
- Press and hold the  key to revalidate the current programming.

### ➤ 5.3 I Pre-diagnostic menu (depending on the model)

- Stopping the appliance if a cleaning cycle is in progress.
- To access the menu:

OV 3500 - OV 3505 - OV 3510 - RV 4550 -  
Vortex™ 4 PLUS

Press  for at least 5 seconds.

OV 5300 - OV 5330 - RV 4560 - RV 5300 - RV 5400 -  
RV 5470 - RV 5500 - RV 5600

Press  +  for at least 5 seconds.

- The appliance status information scrolls:

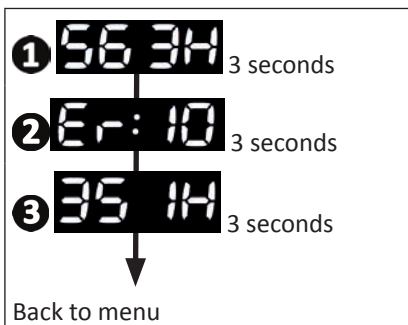

- ① The total operating time (in hours)
- ② The last error code (if the cleaner has had at least one error)
- ③ The operating time during the error (if the cleaner has had at least one error)



**Tip: if you require assistance, inform the retailer about the appliance's condition**



Votre revendeur  
*Your retailer*

Modèle appareil  
*Appliance model*

Numéro de série  
*Serial number*

|  |
|--|
|  |
|  |
|  |

Trouvez plus d'informations et enregistrez votre produit sur  
*More informations and register you product on*

**www.zodiac.com**



Zodiac Pool Care Europe - Boulevard de la Romanerie - BP 90023 - 49180 St Barthélémy d'Anjou cedex - S.A.S.U. au capital de 1 267 140 € / SIREN 395 068 679 / RCS PARIS

